

# Expanded View of Vertical Direct-Mount® System Installation

## A DIRECT-MOUNT DUO™

STABILIZED CONNECTOR WITH INTEGRAL BLOCK VALVE

2 Required

Includes 1" CS Bolts (STD)  
Pressure-Core Stem Seal and Delrin Seat (STD)

Part No.	Description
1500 to 6000 PSIG Service	
AK-147SDT	316 Stainless Steel to NACE

## B FLANGE SEALS

2 Required per Direct-Mount Duo

Part No.	Description
P5-038-R0	PTFE Taylor Mount

## C STABILIZED CONNECTORS DIELECTRIC KITS

1 Kit per Stabilized Connector

1 pc. Design w/316 SS Washers, Bolt Sleeves & Gaskets

Part No.	Description	Option Code
AK-031-C0	CS Bolts	MN
AK-031-C0-W9	316 SS Bolts	MNW9

## D 5-VALVE MANIFOLD

Wide-Pattern™ Style includes 1" CS Bolts & Washers (STD)

Part No.	Description
Up to 1500 PSIG Service	
M3-775SLT	316 Stainless Steel to NACE (Std)
M3-775CLT	Carbon Steel
1500 to 6000 PSIG Service	
M3-775SDT	316 Stainless Steel to NACE
M3-775CDT	Carbon Steel

## E MANIFOLD DIELECTRIC KITS

1 Kit per Manifold

2 pc. Design w/316 SS Washers, Bolt Sleeves & Gaskets

Part No.	Description	Option Code
AK-143-C0	CS Bolts	MY
AK-143-C0-W9	316 SS Bolts	MYW9

## F MANIFOLD FLANGE SEALS

2 Required Per Manifold

Part No.	Description	Option Code
P5-018-R0	PTFE	Standard
P5-075-R0	Viton O-Ring	MH

## G HEX HEAD BOLTS

4 Required Per Manifold

Part No.	Bolt Length	Material	Option Code
P6-067-10	1"	CS	WG (STD)
P6-067-C0	1"	316 SS	WGW9
P6-058-10	1-1/2"	CS	WB
P6-058-C0	1-1/2"	316 SS	WBW9
P6-029-10	2-1/4"	CS	WA
P6-029-C0	2-1/4"	316 SS	WAW9
P6-038-10	2-3/4"	CS	WD
P6-038-C0	2-3/4"	316 SS	WDW9

## H ΔP to STATIC ADAPTER

Optional

Part No.	Description
AK-700 or 701SDT	316 SS (10.5" or 13.5")
AK-700 or 701CDT	Carbon Steel (10.5" or 13.5")

PGI-DMIV 1-2014

Parker Hannifin Corporation  
PGI Division  
16101 Vallen Drive  
Houston, TX 77041 USA

phone 713 466 0056  
pgi\_sales@parker.com  
www.parker.com/pgi

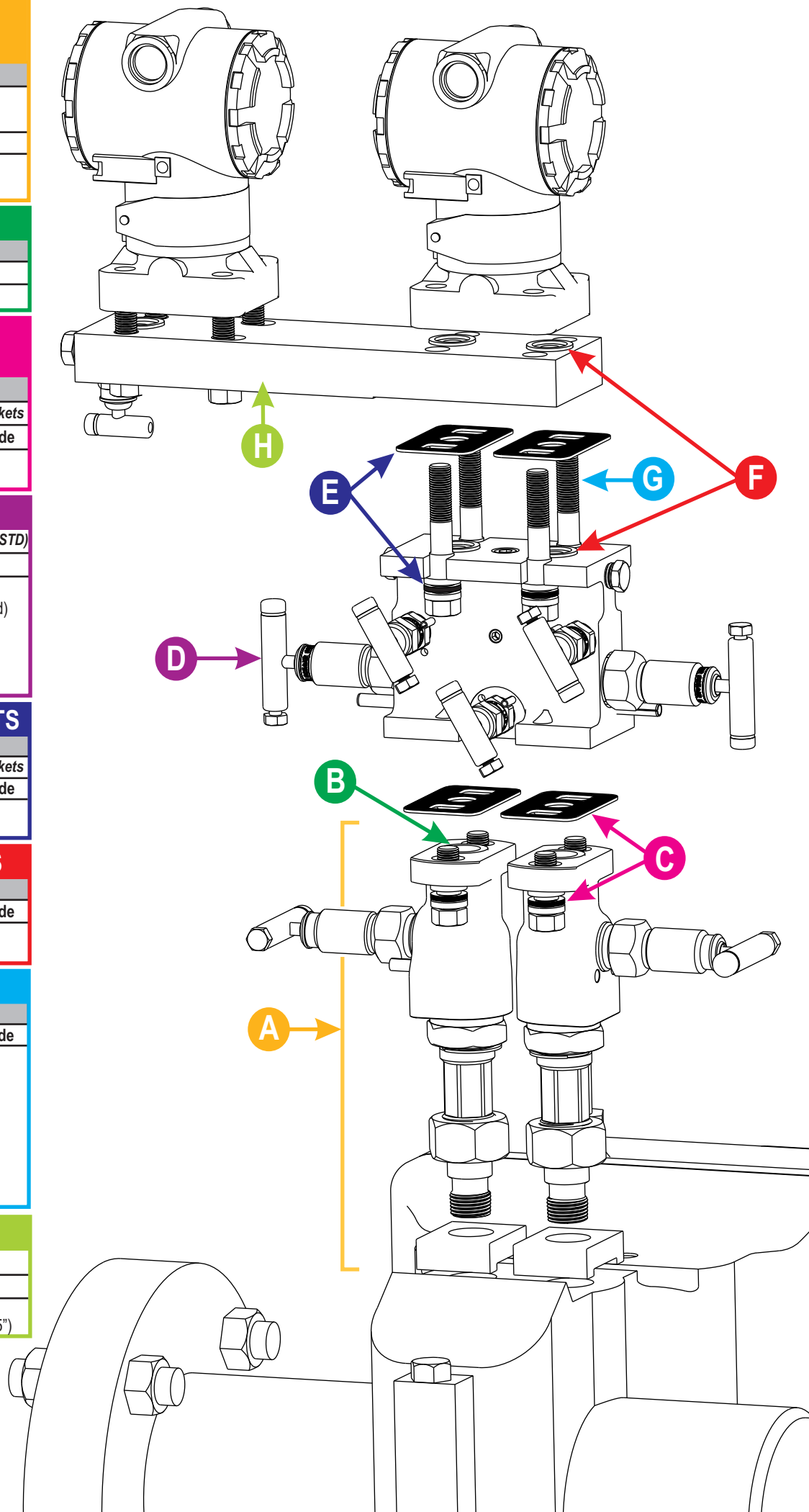

# Expanded View of Horizontal Direct-Mount® System Installation

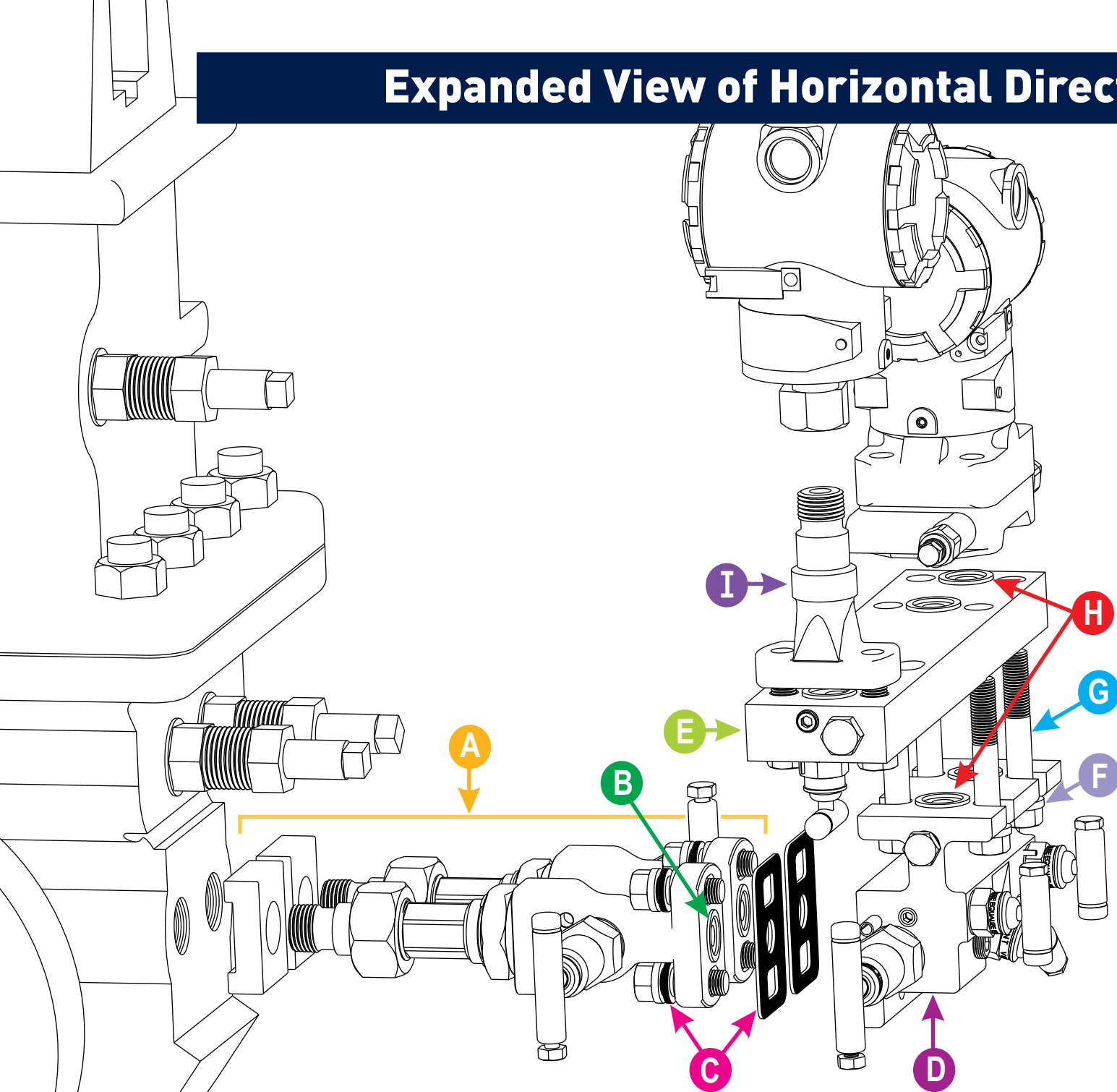

## A DIRECT-MOUNT DUO™ STABILIZED CONNECTOR WITH INTEGRAL BLOCK VALVE

2 Required

Includes 1" CS Bolts (STD)  
Pressure-Core Stem Seal and Delrin Seat (STD)

Part No.	Description
1500 to 6000 PSIG Service	
AK-147SDT	316 Stainless Steel to NACE

## B FLANGE SEALS

2 Required per Direct-Mount Duo

Part No.	Description
P5-038-R0	PTFE Taylor Mount

## C STABILIZED CONNECTORS DIELECTRIC KITS

1 Kit per Stabilized Connector

1 pc. Design w/316 SS Washers, Bolt Sleeves & Gaskets

Part No.	Description	Option Code
AK-031-C0	CS Bolts	MN
AK-031-C0-W9	316 SS Bolts	MNW9

## D 90° 5-VALVE MANIFOLD

Includes 1" CS Bolts & Washers (STD)

Part No.	Description
<b>Up to 1500 PSIG Service</b>	
M3-909SLT	316 Stainless Steel to NACE (Std)
M3-909CLT	Carbon Steel
<b>1500 to 6000 PSIG Service</b>	
M3-909SDT	316 Stainless Steel to NACE
M3-909CDT	Carbon Steel

## E ΔP to STATIC ADAPTER

Optional

Part No.	Description
AK-700 or 701SDT	316 SS (10.5" or 13.5")
AK-700 or 701CDT	Carbon Steel (10.5" or 13.5")

## F BOLT WASHERS

4 Required per Slotted Flange Manifold

Part No.	Description
P6-090-C0	316 SS Bolt Washer
P6-090-10	CS Bolt Washer (STD)

## G HEX HEAD BOLTS

4 Required per Manifold

Part No.	Bolt Length	Material	Option Code
P6-067-10	1"	CS	WG (STD)
P6-067-C0	1"	316 SS	WGW9
P6-058-10	1-1/2"	CS	WB
P6-058-C0	1-1/2"	316 SS	WBW9
P6-029-10	2-1/4"	CS	WA
P6-029-C0	2-1/4"	316 SS	WAW9
P6-038-10	2-3/4"	CS	WD
P6-038-C0	2-3/4"	316 SS	WDW9

## H MANIFOLD FLANGE SEALS

2 Required per Manifold

Part No.	Description	Option Code
P5-018-R0	PTFE	Standard
P5-075-R0	Viton O-Ring	MH

## I STATIC ADAPTERS

Part No.	Description
AK-056-C0	1/2" MNPT Required for FNPT Static Transmitter
AK-055-C0	1/2" FNPT Required for MNPT Static Transmitter

Parker Hannifin Corporation  
PGI Division  
16101 Vallen Drive  
Houston, TX 77041 USA

phone 713 466 0056  
pgi\_sales@parker.com  
www.parker.com/pgi

PGI-DMIH 1-2014

