

Explosion Proof and Non-Incendive Magnetostrictive Level Sensors Series: MPX



The MPX Series Magnetostrictive Level sensor provides highly accurate and repeatable level readings in a wide variety of liquid level measurement applications. The MPX-R's large, buoyant, and robust float allows it to be used in harsh applications where fouling or buildup might otherwise be of concern. The MPX-E's lighter weight design allows it to be used in applications where space is limited. The fiberglass stem of the MPX-G expands the already impressive chemical compatibility of the MPX. And the MPX-F's flexible stainless steel stem allows for accurate measurements in environments that are not straight-forward.

Features

- Class 1 Division 1 Groups C & D, Class 1 Zone 1, Class 1 Zone 2
- Highly accurate and repeatable readings
- 4-20 mA, RS-485 (Modbus RTU) output
- Rugged and reliable, lengths up to 32 feet (9.75 m)
- Dual level (interface) measurement
- Tank volume/level, strapping table



MPX-F Specifications

MPX-F Floats

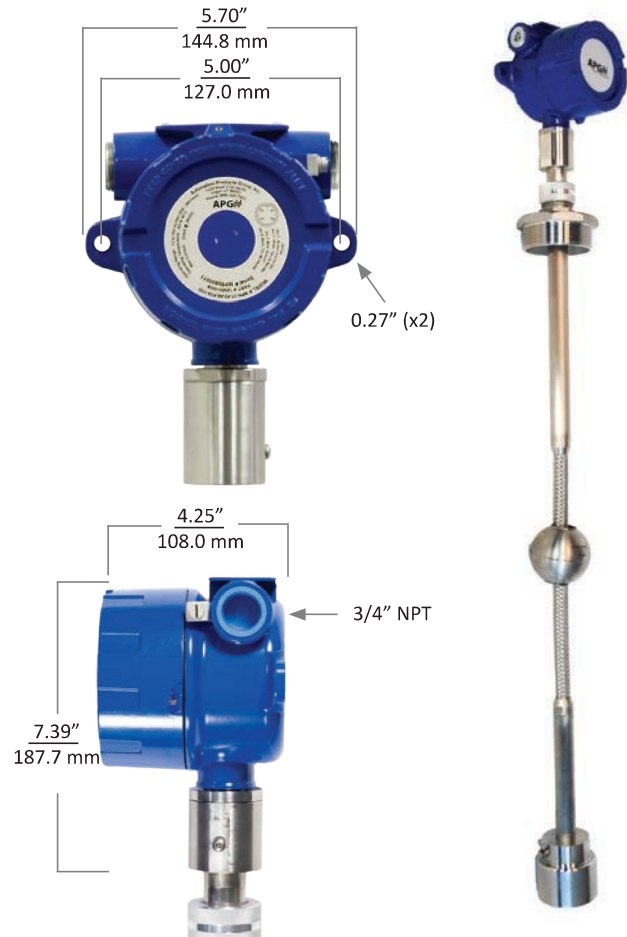
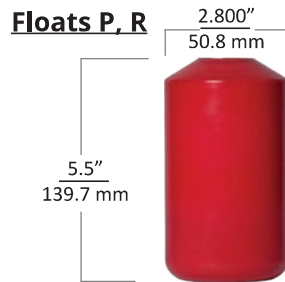
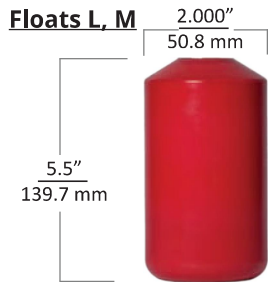
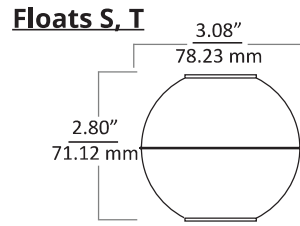
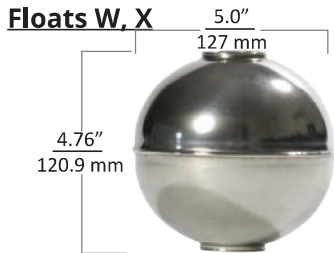
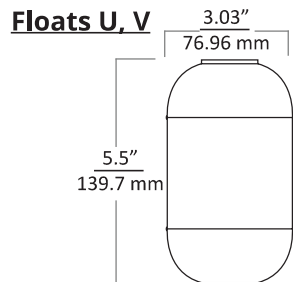
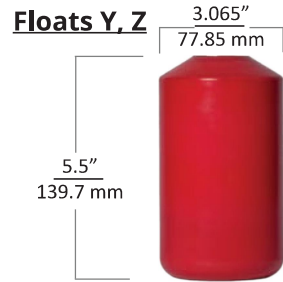

Performance

- Resolution:
 - 4-20 mA: 14 bit DAC
 - Modbus: 0.04 in. (1mm)
- Accuracy: $\pm 0.05\%$ of full scale

Programming

- RS-485: optional RST-6001USB to RS-485 converter
- 4-20 mA: factory set or optional RST-4100 programming module.

Environmental

- Operating Temperature: -40° - 185° F (-40° - 85° C)
- NEMA 4X, IP65

Physical

- Housing: Cast aluminium, epoxy coated
- Stem: $7/8"$ \varnothing Flexible Tubing with Braid, 316L SS
- Stem Length: 10 - 32 ft. (3.05 - 9.75 m)
- Float Sleeve (Floats P & R only):
 - .035" thick Titanium 2

Electrical

- Electrical Connection: Terminal Block, 12-24 VDC
- Total current draw:
 - 4-20 mA: (single) 22 mA, (dual) 44 mA
 - Modbus (RS-485): 28 mA

Connectivity

- Output:
 - Single or dual loop-powered 4-20 mA
 - Modbus RTU (RS-485) with Temperature output

Certification

- NEMA 4X, IP65
- CSA:
 - Class I Division 2 Groups C & D T4 (Ta 85° C)
 - Class I, Zone 2; AEx nA IIB T4
 - Ex nA IIB T4

Tank Cloud



Put Your Tanks In The Cloud

1 Remote Sensors

Connect to any 4-20mA signal or APG Modbus sensor for constant access to your data. Access up to 10 sensors on a single connection.

2 Use the Internet Backbone

Connect the APG sensor or module to the Internet via landline, radio, cellular, or satellite.

3 View Secure Data 24/7

Access sensor data online through our secure portal at levelandflow.com. If the Internet is accessible, so is your information.

4 Stay Up-To-Date

Program custom alarms - receive email and text (sms) message alerts on your computer, mobile phone, or tablet.

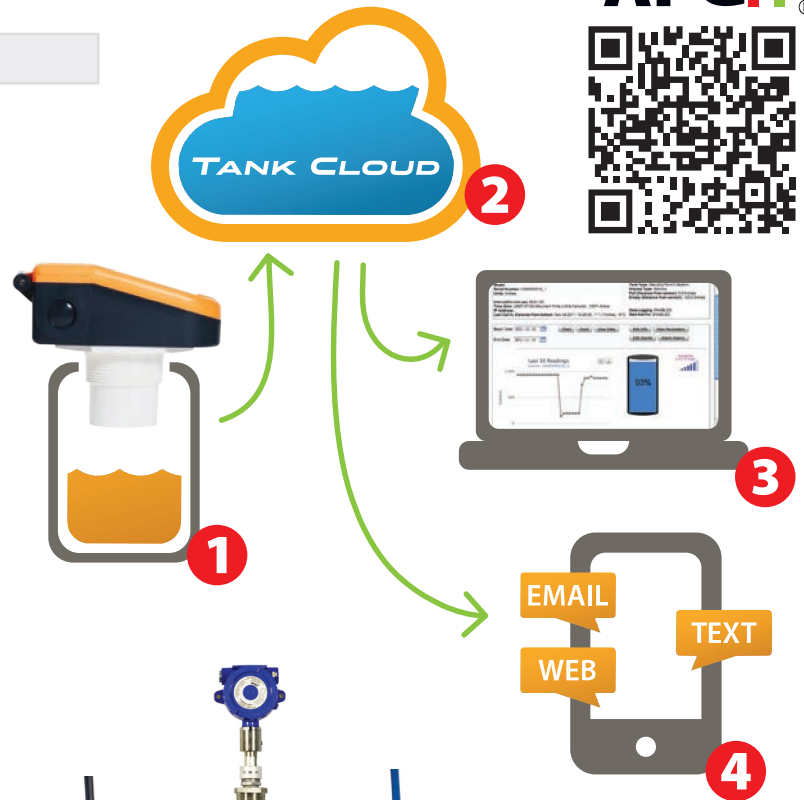

The Line-Up:



Online Data Portal

The Tank Cloud data portal, located online at www.levelandflow.com, displays everything you need to know about your measurement.

Here you can:

- View your current and past readings,
- Manage alarms,
- Configure your sensors,
- and Setup user permissions for others in your organization.

Measurements are sorted by location and grouped into sites. Simply select the site you would like to view, and then choose the sensor. Current readings are prominent in the center of the screen.

Contact us today at 888-525-7300 to set-up a demonstration of our sensors and online software. We are excited to show you how it can impact your business.